

# Connect-A-Dock 2000 Series-High Profile Attachment

## Tools Needed

(1) 9/16" Wrench

## Step 1

Determine port location (Front or Side). Insert 2000 Series XL6 Connectors into float section connector slots.

## Step 2

Secure with bolts, washers, and bushings. Tighten all bolts in the XL6 using 25 lbs/ft (3.46 kg/m) of torque.

## Step 3

Continue by hooking the XL6 over the 2000 Series XL6 Connectors, shift your body weight to the XL6.

## Step 4

Secure with bolts, washers, and bushings. Tighten all bolts in the XL6 using 25 lbs/ft (3.46 kg/m) of torque.

## Instructions for:

2000 Series Attachment Kit

1

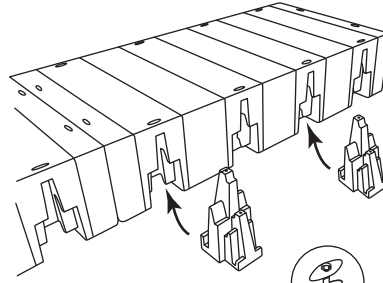

1

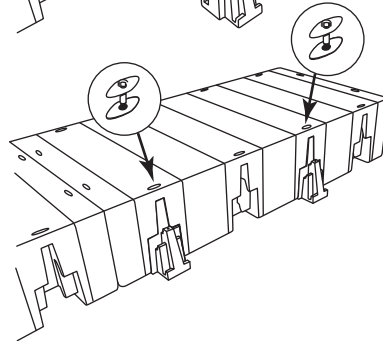

3

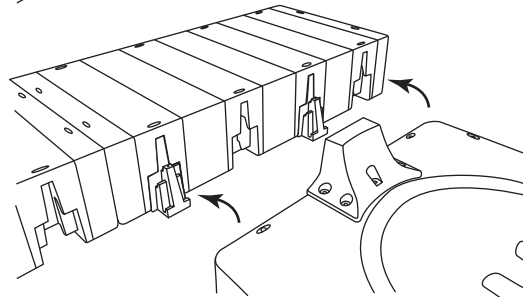

4

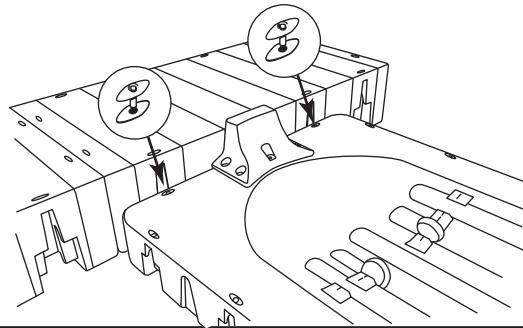

## Installation

Please note that placing a port in an unsuitable location may void any warranty provided by Connect-A-Dock. Please contact PWC Port or your local distributor or dealer if you have any questions regarding the suitability of your particular dock location.

## Cleaning

For low maintenance cleaning use a stiff broom or brush with a garden hose. A pressure washer with no heat can also be used. When using soap, use an environmentally safe product.

## Anchoring

Dock anchoring methods listed in this instruction manual are only suggestions. It is up to you to determine which method suits your needs.

## PWC Port Product Installation and Use Warning Disclaimer

Repairs of a PWC Port should only be performed by an authorized PWC Port technician. If repair is performed by unauthorized persons, serious personal injury and/or property damage could occur.

If unauthorized personnel repair a PWC Port, PWC Port hereby disclaims any and all warranties, expressed or implied. PWC Port limits its warranty to PWC Port's published PWC Port warranty furnished with each product. No other warranty of any kind either verbal or implied including warranties of merchantability and fitness for a particular purpose are recognized.

The contents of this manual are subject to change without notice and should not be construed as a commitment, representation, warranty or guarantee of any method, product or device by PWC Port.

Reproduction or translation of any part of this manual, without the written permission of PWC Port, is prohibited.

Any inquiries concerning the PWC Port published warranty or this manual and its contents please contact PWC Port.

All specifications provided by PWC Port are based upon PWC Port test data and are provided without representation or warranty. Actual specifications, weights and dimensions may vary for a variety of reasons, including, without limitation, due to the rotational molding process. Specifications should be regarded as nominal values only and not as binding actual values. Please contact PWC Port if you have specific questions regarding the specifications of any PWC Port product.

# Connect-A-Port XL6 Bow Stop

## Tools Needed

(2) 9/16" Wrenches

## Step 1

(a) Insert the bolt into the washer and cable loop. Then put the bolt in the hole of the Bow Stop. (b) Secure the bolt with washer and nut from the underside of the Bow Stop.

## Step 2

(a) Align the Bow Stop's feet with the XL6 with the flat side to the outside of the port. (b) Insert the bolt and washer into the four connection points. (c) Secure the Bow Stop with washer and nut from the underside of the XL6.

## Instructions for:

Connect-A-Port XL6

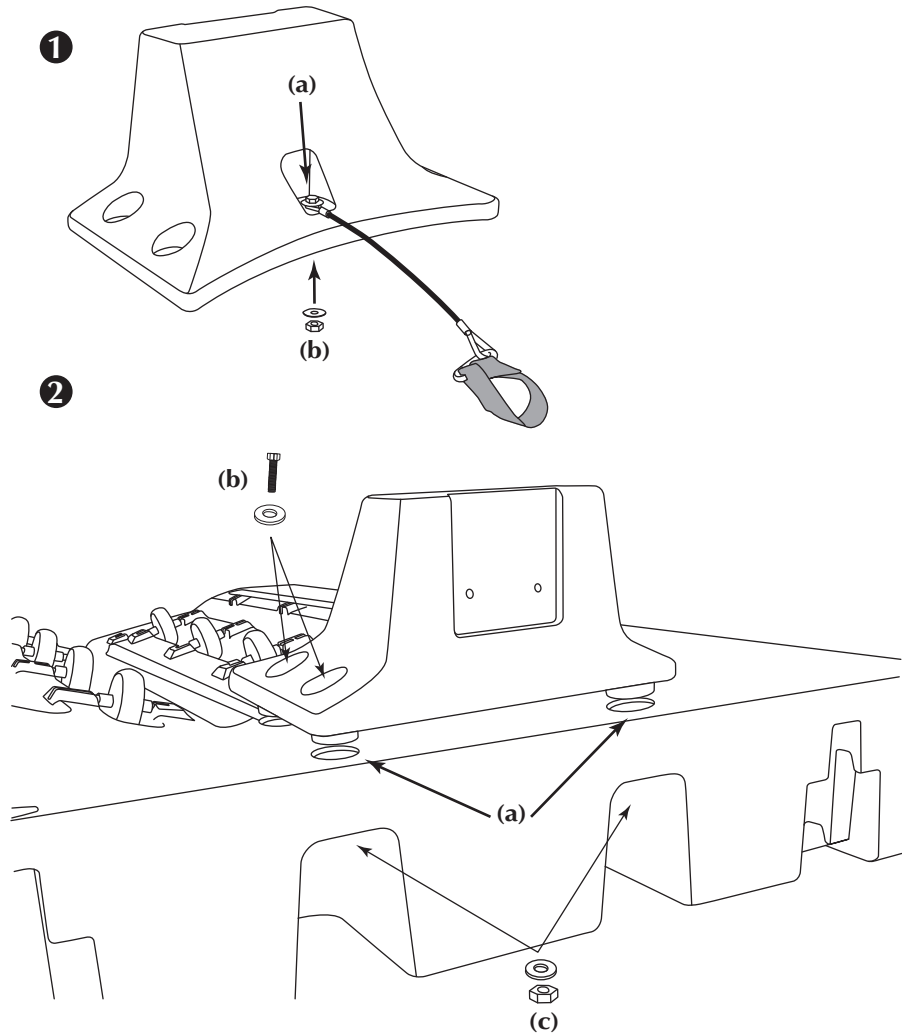

## Installation

Please note that placing a port in an unsuitable location may void any warranty provided by Connect-A-Dock. Please contact PWC Port or your local distributor or dealer if you have any questions regarding the suitability of your particular dock location.

## Cleaning

For low maintenance cleaning use a stiff broom or brush with a garden hose. A pressure washer with no heat can also be used. When using soap, use an environmentally safe product.

## Anchoring

Dock anchoring methods listed in this instruction manual are only suggestions. It is up to you to determine which method suits your needs.

## PWC Port Product Installation and Use Warning Disclaimer

Repairs of a PWC Port should only be performed by an authorized PWC Port technician. If repair is performed by unauthorized persons, serious personal injury and/or property damage could occur.

If unauthorized personnel repair a PWC Port, PWC Port hereby disclaims any and all warranties, expressed or implied. PWC Port limits its warranty to PWC Port's published PWC Port warranty furnished with each product. No other warranty of any kind either verbal or implied including warranties of merchantability and fitness for a particular purpose are recognized.

The contents of this manual are subject to change without notice and should not be construed as a commitment, representation, warranty or guarantee of any method, product or device by PWC Port.

Reproduction or translation of any part of this manual, without the written permission of PWC Port, is prohibited.

Any inquiries concerning the PWC Port published warranty or this manual and its contents please contact PWC Port.

All specifications provided by PWC Port are based upon PWC Port test data and are provided without representation or warranty. Actual specifications, weights and dimensions may vary for a variety of reasons, including, without limitation, due to the rotational molding process. Specifications should be regarded as nominal values only and not as binding actual values. Please contact PWC Port if you have specific questions regarding the specifications of any PWC Port product.

# Connect-A-Port XL6 Floating Dock Attachment

## Tools Needed

- (1) Drill - 1/4" (6.5 mm) & 7/16" (11 mm) drill bit
- (1) 3/4" (18 mm) Wrench
- (2) 9/16" Wrench *Not available in metric*

## Step 1

Slip the XL6 Floating Dock Connectors into each of the connector slots.

## Step 2

Secure each connector with bolt, diamond washer and spacer. Tighten all bolts using 25 lbs/ft (3.46 kg/m) of torque.

## Step 3

(a) Insert the hinge black bushing into the XL6 Hinge Connector. (b) Place the Metal Dock Channel over the XL6 Hinge Connector and align to the hole needed for your dock height. (c) Insert the Hitch Pin thru the Metal Dock Channel and XL6 Hinge Connector. (d) Secure with Hairpin Cotter clip.

## Instructions for:

Connect-A-Port XL6 Front or Side Mounting

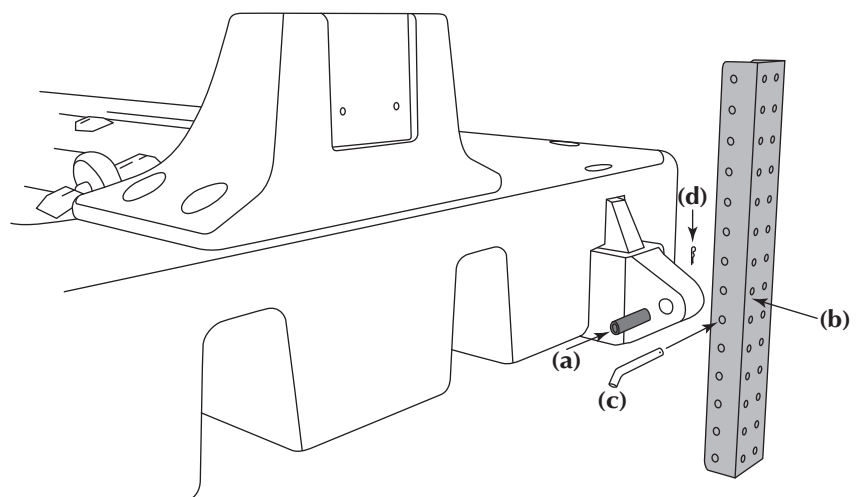
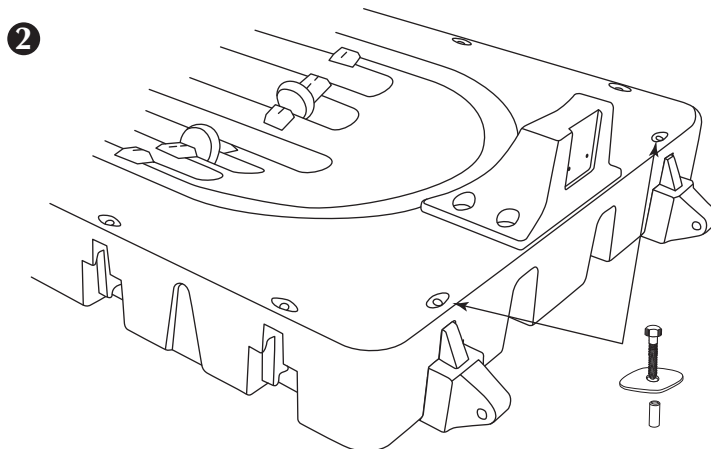
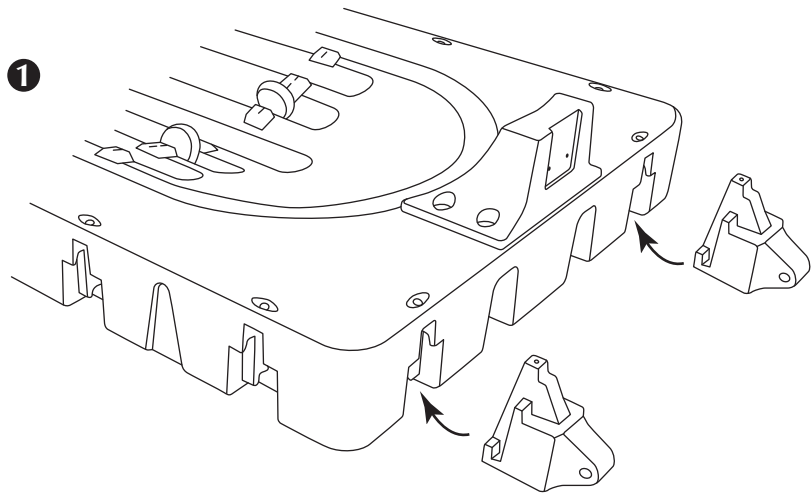

# Connect-A-Port XL6 Floating Dock Attachment

## Step 4

(a) Determine XL6 mounting location. You may want to put your PWC on the port at this time to see how the float set in the water. The entrance end of the port is high with the craft on it you will want to raise the front of the port to give it a slight downhill appearance for easy roll off. Remember, if it rolls off too hard the mount is too low. If it rolls off too easy it is too high.

(b) Mark the drill holes and remove Metal Dock Channel for mounting on the dock. Recommended 4 to 6 mounting holes.

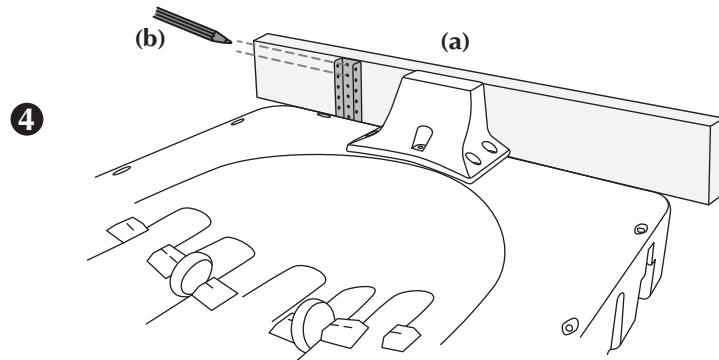

4

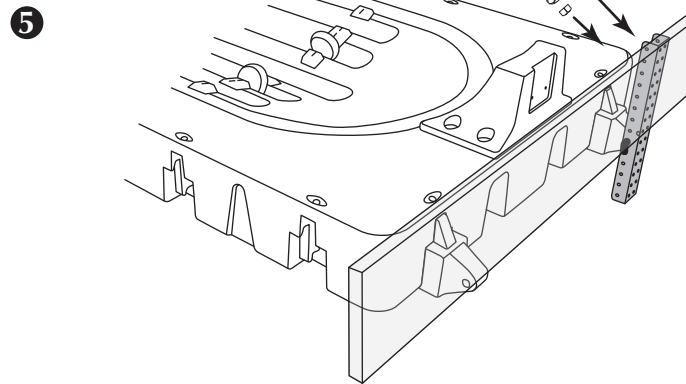

5

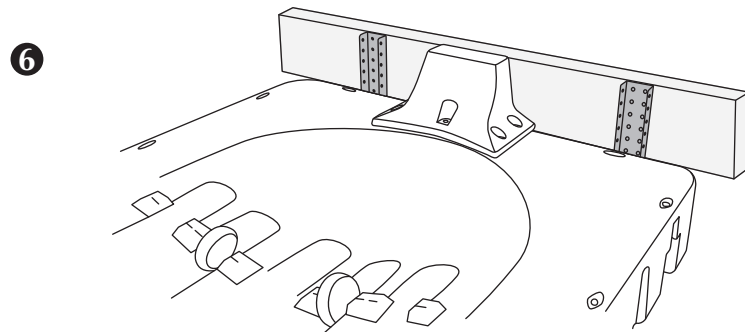

6

## Step 5

**Hardware to mount the XL6 Hinge Connector not included.**

**Attaching with Lag Bolts:**

Mark location for Drilling the (4) 1/4" Pilot holes. Drill the holes. Use 9/16" Wrench to install the 3/8" Lag Bolts.

**Attaching with Bolts, Nuts & Washers:**

Mark location for Drilling the (4) 9/16" Pilot holes. Drill the holes. Use 3/4" Wrench to install the 1/2" Bolts, Nuts & Washers.

(a) Drill the holes for the Bolts. (b) Align Metal Dock Channel to the dock and secure with hardware.

## Step 6

Repeat Steps 3 to 5 for the other anchoring connection.

Note: If mounting port to wooden floating dock use 3/8" (9 mm) Lag Bolts (screw based)

## Installation

Please note that placing a port in an unsuitable location may void any warranty provided by Connect-A-Dock. Please contact PWC Port or your local distributor or dealer if you have any questions regarding the suitability of your particular dock location.

## Cleaning

For low maintenance cleaning use a stiff broom or brush with a garden hose. A pressure washer with no heat can also be used. When using soap, use an environmentally safe product.

## Anchoring

Dock anchoring methods listed in this instruction manual are only suggestions. It is up to you to determine which method suits your needs.

## PWC Port Product Installation and Use Warning Disclaimer

Repairs of a PWC Port should only be performed by an authorized PWC Port technician. If repair is performed by unauthorized persons, serious personal injury and/or property damage could occur.

If unauthorized personnel repair a PWC Port, PWC Port hereby disclaims any and all warranties, expressed or implied. PWC Port limits its warranty to PWC Port's published PWC Port warranty furnished with each product. No other warranty of any kind either verbal or implied including warranties of merchantability and fitness for a particular purpose are recognized.

The contents of this manual are subject to change without notice and should not be construed as a commitment, representation, warranty or guarantee of any method, product or device by PWC Port.

Reproduction or translation of any part of this manual, without the written permission of PWC Port, is prohibited.

Any inquiries concerning the PWC Port published warranty or this manual and its contents please contact PWC Port.

All specifications provided by PWC Port are based upon PWC Port test data and are provided without representation or warranty. Actual specifications, weights and dimensions may vary for a variety of reasons, including, without limitation, due to the rotational molding process. Specifications should be regarded as nominal values only and not as binding actual values. Please contact PWC Port if you have specific questions regarding the specifications of any PWC Port product.

# Connect-A-Port XL6 Moving Rollers

## Tools Needed

- (1) Small Pry Bar
- (1) Dead Blow Hammer

## Step 1

(a) Insert the Pry Bar under the wheel axial. (b) Pry upward to release the axial from the XL6.

## Step 2

(a) Align the roller axle assembly to XL6 roller slot. Secure with a Dead Blow Hammer by tapping the axial on both sides of the roller. The axial should snap into place.

## Wheel Parts

- (a) Roller
- (b) Axle
- (c) Spacer
- (d) Axial Cap

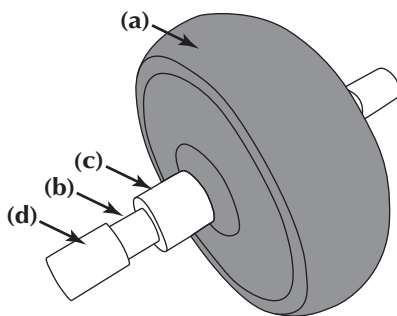

## Instructions for:

### Connect-A-Port XL6 Roller Install

1

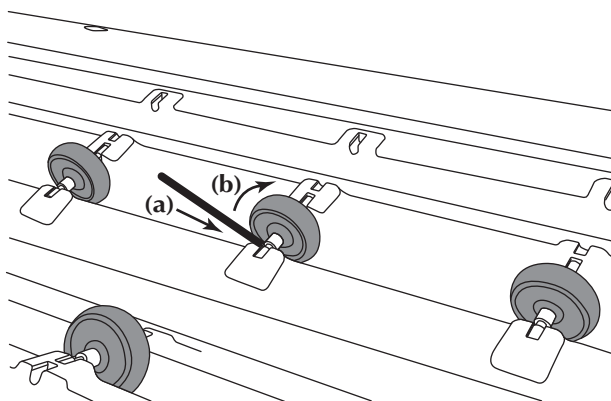

2

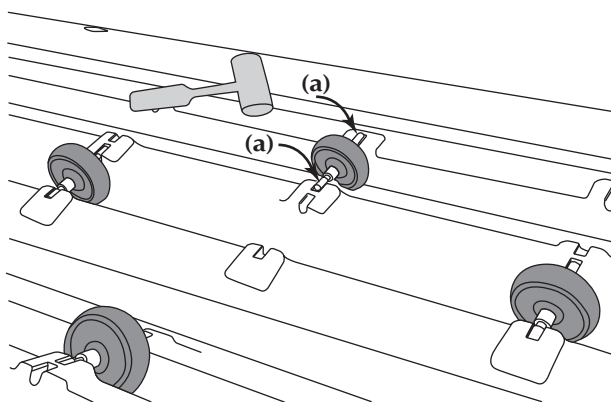

## Installation

Please note that placing a port in an unsuitable location may void any warranty provided by Connect-A-Dock. Please contact PWC Port or your local distributor or dealer if you have any questions regarding the suitability of your particular dock location.

## Cleaning

For low maintenance cleaning use a stiff broom or brush with a garden hose. A pressure washer with no heat can also be used. When using soap, use an environmentally safe product.

## Anchoring

Dock anchoring methods listed in this instruction manual are only suggestions. It is up to you to determine which method suits your needs.

## PWC Port Product Installation and Use Warning Disclaimer

Repairs of a PWC Port should only be performed by an authorized PWC Port technician. If repair is performed by unauthorized persons, serious personal injury and/or property damage could occur.

If unauthorized personnel repair a PWC Port, PWC Port hereby disclaims any and all warranties, expressed or implied. PWC Port limits its warranty to PWC Port's published PWC Port warranty furnished with each product. No other warranty of any kind either verbal or implied including warranties of merchantability and fitness for a particular purpose are recognized.

The contents of this manual are subject to change without notice and should not be construed as a commitment, representation, warranty or guarantee of any method, product or device by PWC Port.

Reproduction or translation of any part of this manual, without the written permission of PWC Port, is prohibited.

Any inquiries concerning the PWC Port published warranty or this manual and its contents please contact PWC Port.

All specifications provided by PWC Port are based upon PWC Port test data and are provided without representation or warranty. Actual specifications, weights and dimensions may vary for a variety of reasons, including, without limitation, due to the rotational molding process. Specifications should be regarded as nominal values only and not as binding actual values. Please contact PWC Port if you have specific questions regarding the specifications of any PWC Port product.

# Connect-A-Port XL6 Fixed Dock

## Tools Needed

9/16" Wrench  
Pole Pounder

## Step 1

Slip the XL6 Pole Connectors into each of the connector slots.

## Step 2

Secure each connector with bolt, diamond washer and spacer. Tighten all bolts using 25 lbs/ft (3.46 kg/m) of torque.

## Step 3

You will need a pipe long enough to drive into the ground. If you have a very secure fixed dock you can mount the pipe to the dock, but if the dock is not of the best integrity mounting to the dock is not recommended because it can work the dock loose in a high wake area. It is recommended that you drive the pipe in the ground and mount it to a fixed dock if applicable. Note: pipe size 2" sch 40 pipe or max dia of 2.375". (50 Dn mm sch 40).

## Instructions for:

Connect-A-Port XL6 Front or Side Mounting

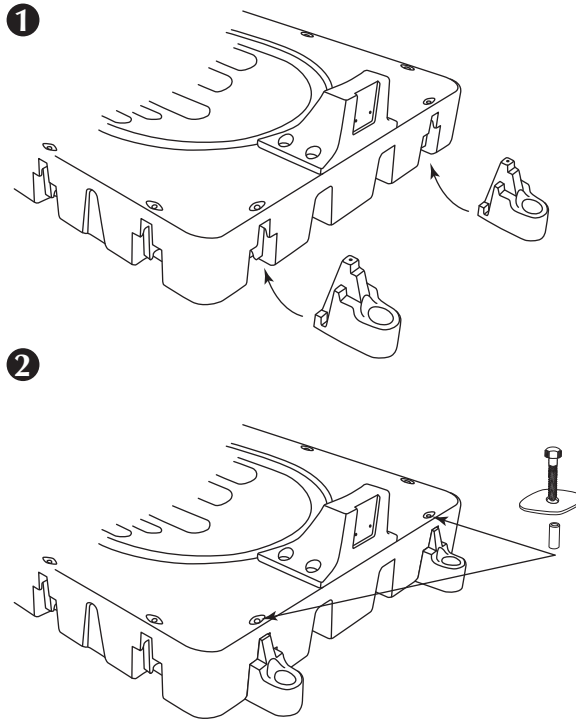

## Installation

Please note that placing a port in an unsuitable location may void any warranty provided by Connect-A-Dock. Please contact PWC Port or your local distributor or dealer if you have any questions regarding the suitability of your particular dock location.

## Cleaning

For low maintenance cleaning use a stiff broom or brush with a garden hose. A pressure washer with no heat can also be used. When using soap, use an environmentally safe product.

## Anchoring

Dock anchoring methods listed in this instruction manual are only suggestions. It is up to you to determine which method suits your needs.

## PWC Port Product Installation and Use Warning Disclaimer

Repairs of a PWC Port should only be performed by an authorized PWC Port technician. If repair is performed by unauthorized persons, serious personal injury and/or property damage could occur.

If unauthorized personnel repair a PWC Port, PWC Port hereby disclaims any and all warranties, expressed or implied. PWC Port limits its warranty to PWC Port's published PWC Port warranty furnished with each product. No other warranty of any kind either verbal or implied including warranties of merchantability and fitness for a particular purpose are recognized.

The contents of this manual are subject to change without notice and should not be construed as a commitment, representation, warranty or guarantee of any method, product or device by PWC Port.

Reproduction or translation of any part of this manual, without the written permission of PWC Port, is prohibited.

Any inquiries concerning the PWC Port published warranty or this manual and its contents please contact PWC Port.

All specifications provided by PWC Port are based upon PWC Port test data and are provided without representation or warranty. Actual specifications, weights and dimensions may vary for a variety of reasons, including, without limitation, due to the rotational molding process. Specifications should be regarded as nominal values only and not as binding actual values. Please contact PWC Port if you have specific questions regarding the specifications of any PWC Port product.



# Connect-A-Port XL6 Fixed Dock

## Tools Needed

9/16" Wrench  
Pole Pounder

## Step 4

**Hardware to mount the Pole Sleeve Bracket not included.**

### Attaching with Lag Bolts:

Mark location for Drilling the (4) 1/4" Pilot holes. & Drill the holes.  
Use 9/16" Wrench to install the 3/8" Lag Bolts.

### Attaching with Bolts, Nuts & Washers:

Mark location for Drilling the (4) 9/16" Pilot holes. Drill the holes.  
Use 3/4" Wrench to install the 1/2" Bolts, Nuts & Washers.  
(a) Drill the holes for the Bolts. (b) Align Metal Dock Channel to the dock and secure with hardware.

## Step 5

Determine XL6 position to fixed dock. (A) Mount one Pole Sleeve Bracket on the outside of the fixed dock. Note: 3/8" hardware to mount the Pole Sleeve Bracket not included. (B) Slide 2" I.D. pole through Pole Sleeve Bracket and Pole connector. Note: pipe size 2" I.D. sch 40 pipe or max dia of 2.375". (50 Dn mm sch 40)

## Step 6

(A) Slide 2" id pole through Pole Connector. (B) Slide the Pole Sleeve Bracket down the 2" id Pole and align with the Fixed Dock. Mount Pole Sleeve Bracket to the Fixed Dock with 3/8" hardware.

## Instructions for:

Connect-A-Port XL6 Front or Side Mounting

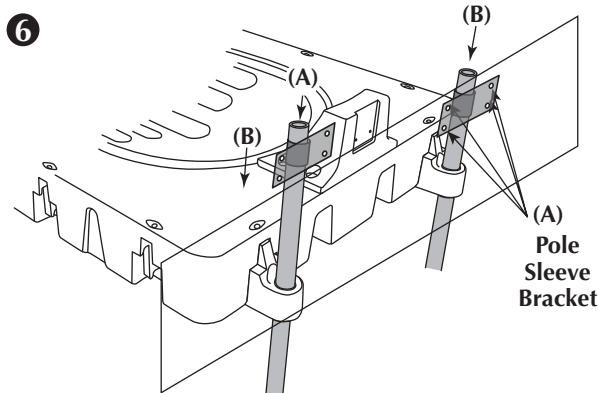
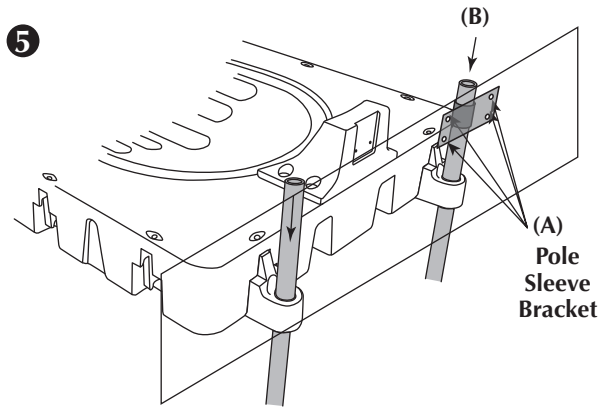

## Installation

Please note that placing a port in an unsuitable location may void any warranty provided by Connect-A-Dock. Please contact PWC Port or your local distributor or dealer if you have any questions regarding the suitability of your particular dock location.

## Cleaning

For low maintenance cleaning use a stiff broom or brush with a garden hose. A pressure washer with no heat can also be used. When using soap, use an environmentally safe product.

## Anchoring

Dock anchoring methods listed in this instruction manual are only suggestions. It is up to you to determine which method suits your needs.

## PWC Port Product Installation and Use Warning Disclaimer

Repairs of a PWC Port should only be performed by an authorized PWC Port technician. If repair is performed by unauthorized persons, serious personal injury and/or property damage could occur.

If unauthorized personnel repair a PWC Port, PWC Port hereby disclaims any and all warranties, expressed or implied. PWC Port limits its warranty to PWC Port's published PWC Port warranty furnished with each product. No other warranty of any kind either verbal or implied including warranties of merchantability and fitness for a particular purpose are recognized.

The contents of this manual are subject to change without notice and should not be construed as a commitment, representation, warranty or guarantee of any method, product or device by PWC Port.

Reproduction or translation of any part of this manual, without the written permission of PWC Port, is prohibited.

Any inquiries concerning the PWC Port published warranty or this manual and its contents please contact PWC Port.

All specifications provided by PWC Port are based upon PWC Port test data and are provided without representation or warranty. Actual specifications, weights and dimensions may vary for a variety of reasons, including, without limitation, due to the rotational molding process. Specifications should be regarded as nominal values only and not as binding actual values. Please contact PWC Port if you have specific questions regarding the specifications of any PWC Port product.

# Connect-A-Port XL6 Side by Side

## Tools Needed

(1) 9/16" Wrench

## Step 1

Slip the XL6 Side By Side Connectors into each of the three connector slots.

## Step 2

Secure each connector with bolt, diamond washer and spacer. Tighten all bolts using 25 lbs/ft (3.46 kg/m) of torque.

## Step 3

Align the next XL6 with the Side By Side Connectors. Position yourself carefully on the XL6 with the connectors. Continue adding the next XL6 by placing them over the Side By Side Connectors. Shift your body weight to the new XL6.

## Step 4

Secure each connector with bolt, diamond washer and spacer. Tighten all bolts using 25 lbs/ft (3.46 kg/m) of torque.

## Instructions for:

Connect-A-Port XL6 Front or Side Mounting

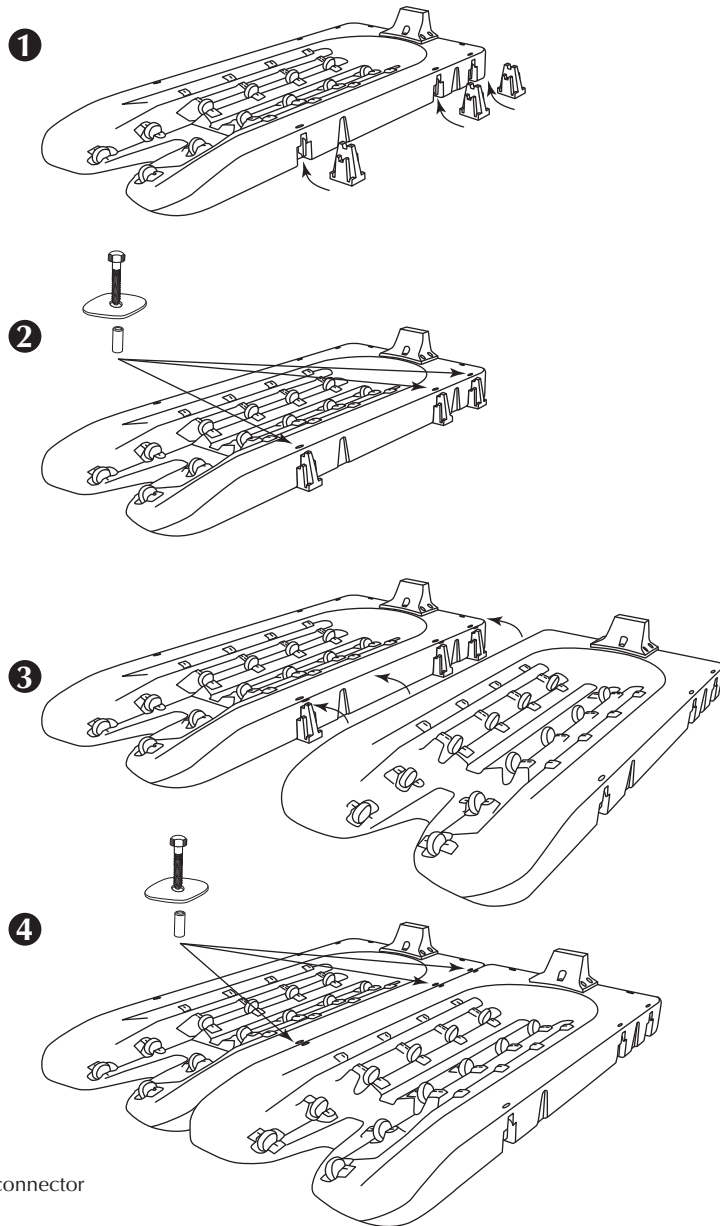

Note: Check all bolts every three months or as needed to insure all connector hardware is securely fastened.

## Installation

Please note that placing a port in an unsuitable location may void any warranty provided by Connect-A-Dock. Please contact PWC Port or your local distributor or dealer if you have any questions regarding the suitability of your particular dock location.

## Cleaning

For low maintenance cleaning use a stiff broom or brush with a garden hose. A pressure washer with no heat can also be used. When using soap, use an environmentally safe product.

## Anchoring

Dock anchoring methods listed in this instruction manual are only suggestions. It is up to you to determine which method suits your needs.

## PWC Port Product Installation and Use Warning Disclaimer

Repairs of a PWC Port should only be performed by an authorized PWC Port technician. If repair is performed by unauthorized persons, serious personal injury and/or property damage could occur.

If unauthorized personnel repair a PWC Port, PWC Port hereby disclaims any and all warranties, expressed or implied. PWC Port limits its warranty to PWC Port's published PWC Port warranty furnished with each product. No other warranty of any kind either verbal or implied including warranties of merchantability and fitness for a particular purpose are recognized.

The contents of this manual are subject to change without notice and should not be construed as a commitment, representation, warranty or guarantee of any method, product or device by PWC Port.

Reproduction or translation of any part of this manual, without the written permission of PWC Port, is prohibited.

Any inquiries concerning the PWC Port published warranty or this manual and its contents please contact PWC Port.

All specifications provided by PWC Port are based upon PWC Port test data and are provided without representation or warranty. Actual specifications, weights and dimensions may vary for a variety of reasons, including, without limitation, due to the rotational molding process. Specifications should be regarded as nominal values only and not as binding actual values. Please contact PWC Port if you have specific questions regarding the specifications of any PWC Port product.